

## Straight & Angle 90° Industrial Thermometer

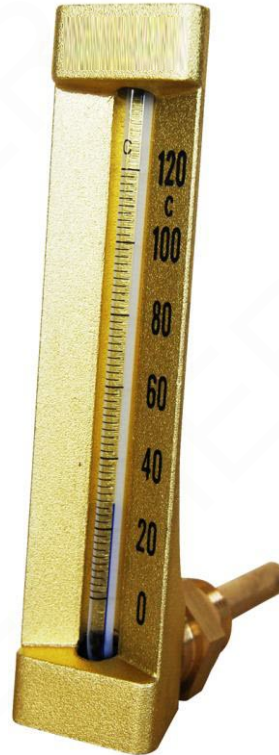

ISO 9001 : 2015

- Size :** Height 150 to 200
- Ends :** Male 1/2" BSP
- Min Temperature :** - 30°C
- Max Temperature :** + 300°C
- Max Pressure :** 16 Bars
- Specifications :** Aluminium body  
Easy reading thanks to prismatic glass tube form  
Brass fitting  
Engraving graduated glass

**Materials :** Aluminium body

**SPECIFICATIONS :**

- Aluminium body
- Easy reading thanks to prismatic glass tube form
- Brass fitting
- Engraving graduated glass
- Plunger Ø 10 mm
- Threaded male 1/2" BSP
- Accuracy class 2.5%

**USE :**

- Not for viscous or crystallizing liquid
- Min and max Temperature Ts :- 30°C to + 300°C
- Max Pressure Ps : 16 bars

**RANGE :**

- Bottom connection 150 mm height with 63 mm plunger, graduation from 0 to + 120°C **Ref. 1670001**
- Bottom connection 150 mm height with 63 mm plunger, graduation from -30 to + 50°C **Ref. 1670002**
  
- Bottom connection 200 mm height with 63 mm plunger, graduation from 0 to + 120°C **Ref. 1671001**
- Bottom connection 200 mm height with 63 mm plunger, graduation from -30 to + 50°C **Ref. 1671002**
- Bottom connection 200 mm height with 63 mm plunger, graduation from 0 to + 200°C **Ref. 1671003**
- Bottom connection 200 mm height with 63 mm plunger, graduation from 0 to + 300°C **Ref. 1671004**
  
- Bottom connection 150 mm height with 100 mm plunger, graduation from 0 to + 120°C **Ref. 1672001**
- Bottom connection 150 mm height with 100 mm plunger, graduation from -30 to + 50°C **Ref. 1672002**
  
- Bottom connection 200 mm height with 100 mm plunger, graduation from 0 to + 120°C **Ref. 1673001**
- Bottom connection 200 mm height with 100 mm plunger, graduation from -30 to + 50°C **Ref. 1673002**
- Bottom connection 200 mm height with 100 mm plunger, graduation from 0 to + 200°C **Ref. 1673003**
- Bottom connection 200 mm height with 100 mm plunger, graduation from 0 to + 300°C **Ref. 1673004**
  
- Angle connection 150 mm height with 63 mm plunger, graduation from 0 to + 120°C **Ref. 1675001**
- Angle connection 150 mm height with 63 mm plunger, graduation from -30 to + 50°C **Ref. 1675002**
  
- Angle connection 200 mm height with 63 mm plunger, graduation from 0 to + 120°C **Ref. 1676001**
- Angle connection 200 mm height with 63 mm plunger, graduation from -30 to + 50°C **Ref. 1676002**
- Angle connection 200 mm height with 63 mm plunger, graduation from 0 to + 200°C **Ref. 1676003**
- Angle connection 200 mm height with 63 mm plunger, graduation from 0 to + 300°C **Ref. 1676004**
  
- Angle connection 150 mm height with 100 mm plunger, graduation from 0 to + 120°C **Ref. 1677001**
- Angle connection 150 mm height with 100 mm plunger, graduation from -30 to + 50°C **Ref. 1677002**
  
- Angle connection 200 mm height with 100 mm plunger, graduation from 0 to + 120°C **Ref. 1678001**
- Angle connection 200 mm height with 100 mm plunger, graduation from -30 to + 50°C **Ref. 1678002**
- Angle connection 200 mm height with 100 mm plunger, graduation from 0 to + 200°C **Ref. 1678003**
- Angle connection 200 mm height with 100 mm plunger, graduation from 0 to + 300°C **Ref. 1678004**

**ACCESSORIES :**



- Brass glove finger 1/2" BSP threaded
  - For plunger 63 mm Ref. 9880220
  - For plunger 100 mm Ref. 9880221

**MATERIALS :**

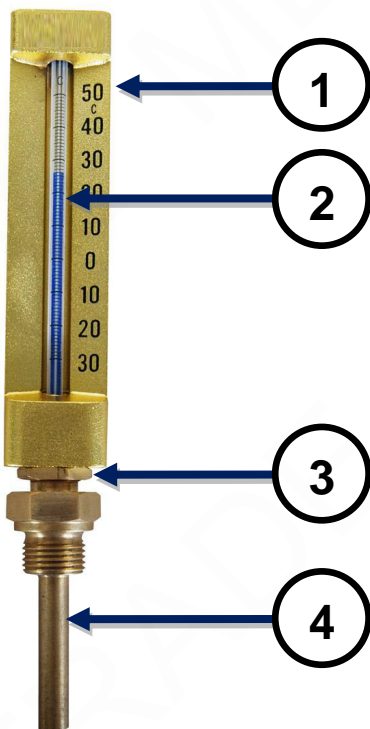

Item	DESIGNATION	MATERIALS
1	Body	Aluminium
2	Glass tube	Prismatic glass
3	Fitting	Brass
4	Plunger	Brass (up to 200°C)
4	Plunger	SS 304 (up to 300°C)*

\* Ref. 1671004, 1673004, 1676004 et 1678004

**THERMOMETERS SIZE ( in mm ):**

**Ref. 1670-1671-1672-1673**

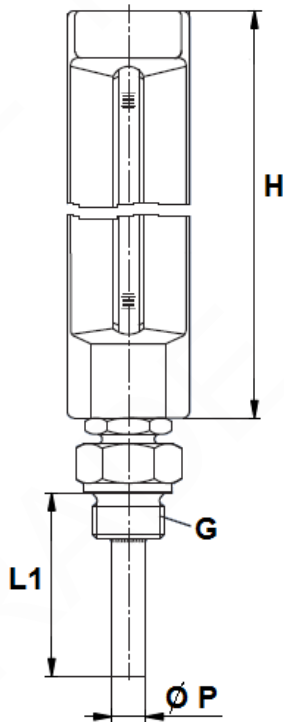

**Ref. 1675-1676-1677-1678**

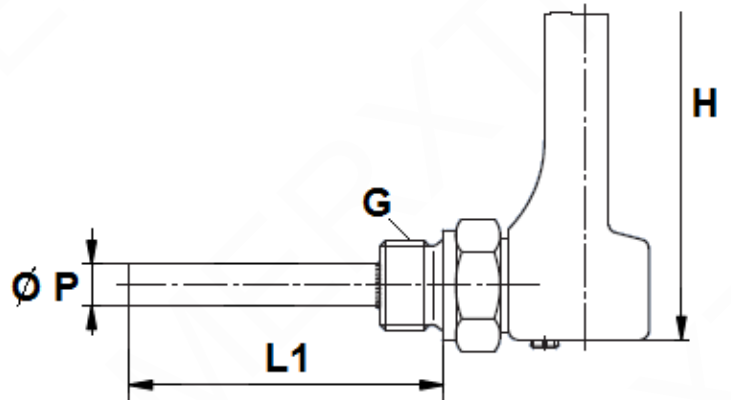

Ref.	1670	1671	1672	1673	1675	1676	1677	1678
H	150	200	150	200	150	200	150	200
L1	63	63	100	100	63	63	100	100
G	1/2"	1/2"	1/2"	1/2"	1/2"	1/2"	1/2"	1/2"
Ø P	10	10	10	10	10	10	10	10
Weight ( kg )	0.260	0.310	0.280	0.330	0.260	0.310	0.280	0.330

**GLOVE FINGER SIZE ( in mm ) :**

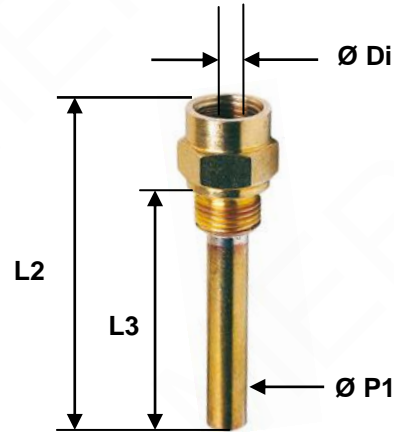

Ref.	9880220	9880221
L2	75	110
L3	50	86
Ø Di	11	11
Ø P1	14	14
Weight ( Kg )	0.130	0.135

**STANDARDS :**

- Fabrication according to **ISO 9001 : 2015**
- Designing according to **DIN 16189 et DIN 16190**
- **DIRECTIVE 2014/68/EU** : Products excluded from directive ( article 4, § 3 )

**ADVICE :** Our opinion and our advice are not guaranteed and MerxTrade shall not be liable for the consequences of damages. The customer must check the right choice of the products with the real service conditions.